



# TACOMA

2005

*Pocket Reference Guide*





*moving forward* ▶

## 2005 Tacoma

This *Pocket Reference Guide* is a summary guide for basic vehicle operations. It contains brief descriptions of fundamental operations so you can locate and use the vehicle's main equipment quickly and easily.

The *Pocket Reference Guide* is not intended as a substitute for the *Owner's Manual* located in your vehicle's glove box. We strongly encourage you to review the *Owner's Manual* and supplementary manuals so you will have a better understanding of your vehicle's capabilities and limitations.

Your dealership and the entire staff of Toyota Motor Sales, U.S.A., Inc., wish you many years of satisfied driving in your new Tacoma.

### **! A word about safe vehicle operations**

This *Pocket Reference Guide* is not a full guide to Tacoma operations. Every Tacoma owner should review the *Owner's Manual* that accompanies this vehicle.

Pay special attention to the boxed information highlighted in yellow throughout the *Owner's Manual*. Each box contains safe operating instructions to help you avoid injury or equipment malfunction.

All information in this *Pocket Reference Guide* is current at the time of printing. Toyota reserves the right to make changes at any time without notice.

# TABLE OF CONTENTS

Item	Page no.
<b>OVERVIEW</b>	
Engine compartment	7
Fuel tank door and cap	6
Hood release lever	6
Indicator symbols	4-5
Instrument cluster	4-5
Instrument panel	2-3
<b>FEATURES/OPERATIONS</b>	
Accessory meter	10
Air conditioning/Heating	16
Audio	14-15
Auto LSD (Auto Limited Slip Differential)	19
Automatic transmission	8
Bottle holders	17
Clock	12
Clutch start cancel switch	19
Cruise control	13
Cup holders	17
Engine immobilizer	17
Four-wheel drive	9
Keyless entry	18
Lights & turn signals	11
Parking brake	12
Power outlets	16
Rear differential lock	18
Seat adjustments-Front	10
Seats-Head restraints	10
Tilt and telescopic steering wheel	9
Window-Rear sliding	12
Windows	13
Windshield wiper & washer	11
<b>SAFETY AND EMERGENCY FEATURES</b>	
Airbag-Supplemental Restraint System	22-23
DAC (Downhill Assist Control)	21
Door locks	20
Doors-Child safety locks	20
HAC (Hill-start Assist Control)	21
Passenger airbag cutoff switch	22
Rollover information	24
Seat belts	20
Seat belts-Shoulder belt anchor	21
Spare tire & tools	25
TRAC (Traction Control)	21
VSC (Vehicle Stability Control)	21

# OVERVIEW

## Instrument panel

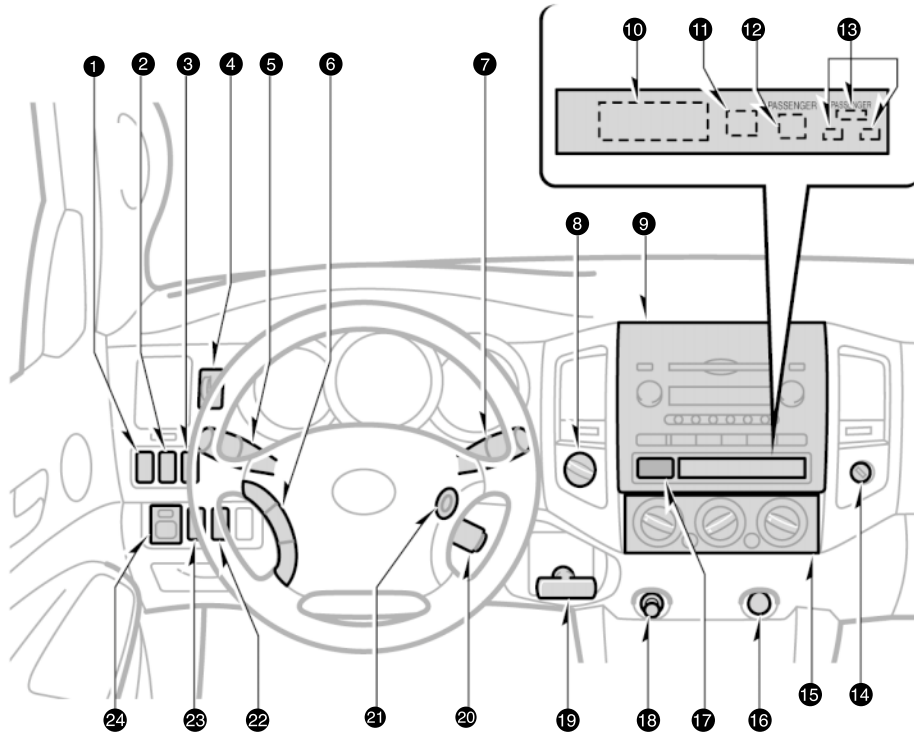

- ❶ Front fog light switch\*
- ❷ "AUTO LSD" (Auto Limited Slip Differential) or Rear Differential Lock switch\*
- ❸ Power outlet main switch\*
- ❹ Dimmer control wheel
- ❺ Headlight and turn signal controls
- ❻ Audio steering wheel switches
- ❼ Wiper and washer controls
- ❽ Two-wheel/Four-wheel drive selector\*
- ❾ Audio
- ❿ Clock
- ⓫ Theft deterrent system/Engine immobilizer indicator light\*
- ⓬ Front passenger's seat belt reminder light
- ⓭ Front passenger occupant classification indicator lights\* or front passenger airbag on-off indicator lights\*

- ⓮ Passenger airbag cutoff switch\*
- ⓯ Air conditioning controls
- ⓰ Power outlet
- ⓱ Emergency flasher switch
- ⓲ Cigarette lighter
- ⓳ Parking brake lever (stick type)
- ⓴ Cruise control lever\*
- ⓵ Ignition switch
- ⓶ Clutch start cancel switch\*
- ⓷ "DAC" (Downhill Assist Control) button\*
- ⓸ Power rear view mirror controls\*

\*If installed

## Instrument cluster

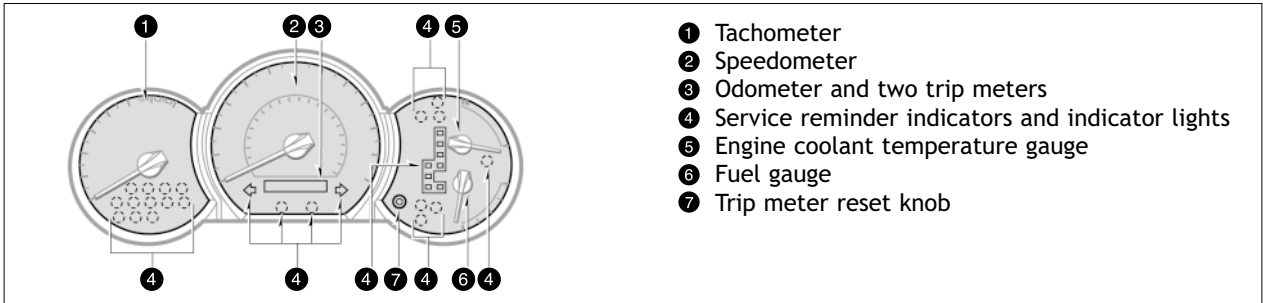

## Indicator symbols

	Brake system warning light <sup>1</sup>
	Driver's seat belt reminder light <sup>1</sup>
	Front passenger's seat belt reminder light <sup>1</sup>
	Battery warning light <sup>1</sup>
	Front passenger occupant classification indicator light or passenger airbag on-off indicator light
	Low engine oil pressure warning light <sup>1</sup>
	Malfunction indicator light <sup>1</sup>
	Engine oil replacement reminder light <sup>1</sup>
	Anti-lock brake system warning light <sup>1</sup>

### CAUTION

When the anti-lock brake system (ABS) function is in action, you may feel the brake pedal pulsating and hear a noise. In this situation, to let the anti-lock brake system work for you, just hold the brake pedal down more firmly. Do not pump the brake as this will result in reduced braking performance.

### VSC TRAC

- Vehicle stability control warning light<sup>1</sup>
- "AUTO LSD" warning light<sup>1</sup>
- Traction control warning light<sup>1</sup>
- Downhill assist control warning light<sup>1</sup>
- Hill-start assist control warning light<sup>1</sup>

	Open door warning light <sup>1</sup>
	Airbag SRS warning light <sup>1</sup>
	Automatic transmission fluid temperature warning light <sup>1</sup>
	Theft deterrent/Engine immobilizer indicator light
	Headlight low beam indicator light
	Headlight high beam indicator light
	Turn signal indicator light
	Automatic transmission indicator lights (5-speed) / (4-speed)
	Four-wheel drive indicator light <sup>2</sup>
	Low speed four-wheel drive indicator light <sup>2</sup>
	Rear differential lock indicator light <sup>3</sup>
	Slip indicator light
	Vehicle stability control system off indicator light
	Downhill assist control indicator light
	"AUTO LSD" indicator light
	Cruise control indicator light <sup>4</sup>

<sup>1</sup> For details, refer to "Service reminder indicators and warning buzzers," Section 1-6, 2005 Owner's Manual.

<sup>2</sup> If this light flashes, refer to "Four-wheel drive system," Section 1-7, 2005 Owner's Manual.

<sup>3</sup> If this light flashes, refer to "Rear differential lock system," Section 1-7, 2005 Owner's Manual.

<sup>4</sup> If this light flashes, refer to "Cruise control," Section 1-7, 2005 Owner's Manual.

## Fuel tank door and cap

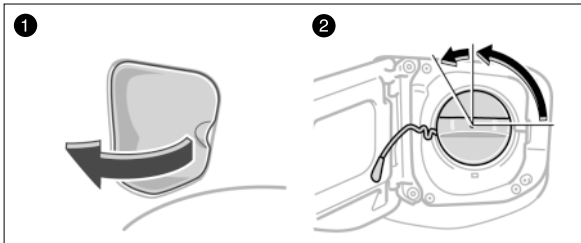

- 1 Fuel tank door.
- 2 To remove the fuel tank cap Turn the cap counterclockwise by 90 degrees, then turn it an additional 30 degrees. Pause slightly before removing it.

## Hood release lever

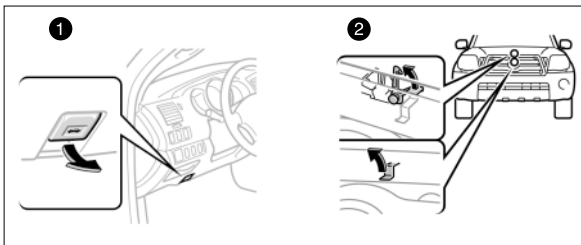

- 1 To release the hood Pull the lever inside vehicle.
- 2 To open the hood There are two levers that will open the hood. Insert finger either through the opening between the hood and grill, or through the grill. Pull up on one of the catch levers inside the compartment and lift the hood.

## Engine compartment

### 4 cylinder (2TR-FE) engine

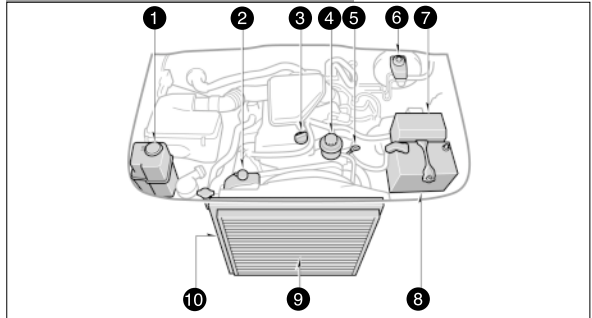

### 6 cylinder (1GR-FE) engine

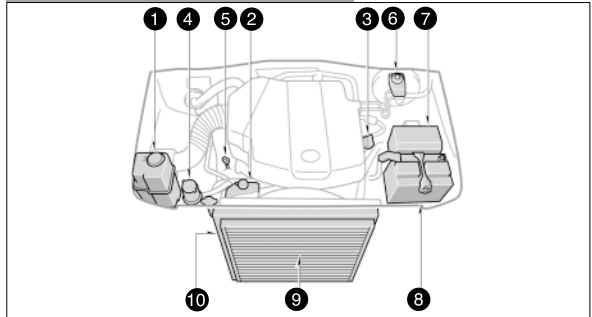

- 1 Windshield washer fluid tank
- 2 Engine coolant reservoir
- 3 Engine oil filler cap
- 4 Power steering fluid reservoir
- 5 Engine oil level dipstick
- 6 Brake fluid reservoir
- 7 Fuse block
- 8 Battery
- 9 Condenser
- 10 Radiator

**Note:** Regularly scheduled maintenance, including oil changes, will help extend the life of your vehicle and maintain performance. Please refer to the "Owner's Warranty Information Booklet," "Scheduled Maintenance Guide" or "Owner's Manual Supplement."

# FEATURES/OPERATIONS

## Automatic transmission (if installed)

### 5-speed models

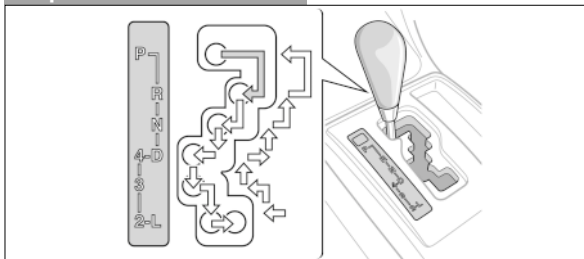

### 4-speed models

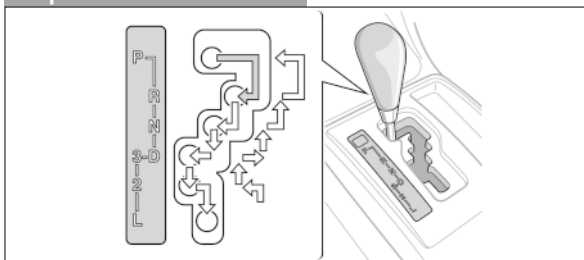

↓ When shifting from “P” (Park), the ignition switch must be “ON,” and the brake pedal depressed.

↕ Shift normally.

<b>P</b>	Park Engine starting and key removal
<b>R</b>	Reverse
<b>N</b>	Neutral
<b>D</b>	Drive Overdrive “ON”*
<b>4</b>	Fourth gear 5-speed models only ... Overdrive “OFF”
<b>3</b>	Third gear 5-speed models ... Increased engine braking 4-speed models ... Overdrive “OFF”
<b>2</b>	Second gear Increased engine braking
<b>L</b>	First gear Maximum engine braking

\*Downshifting increases power going uphill, or provides engine braking going downhill. For best fuel economy during normal driving conditions, always drive with the shift lever in the “D” position.

## Four-wheel drive (if installed)

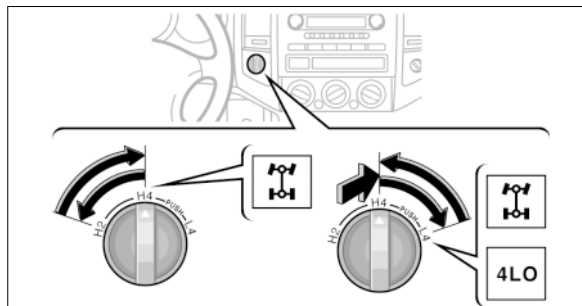

To operate the two-wheel/four-wheel drive selector

- H2** ↔ **H4** Turn
- H4** → **L4** Push and Turn
- H4** ← **L4** Turn

- H2** High speed position, two-wheel drive
- H4** High speed position, four-wheel drive
- L4** Low speed position, four-wheel drive

For best fuel economy during normal driving conditions, drive in the “H2” position.

Refer to your *Owner’s Manual* for more details.

## Tilt and telescopic steering wheel

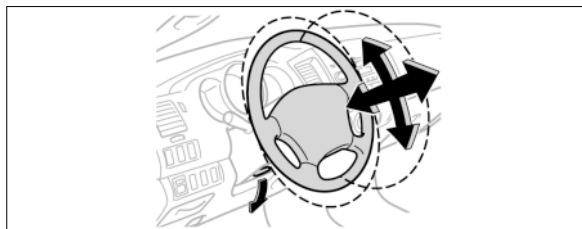

To change the steering wheel position Push the lock release lever down, set the desired length and angle, and return the lever to its original position.  
**Note: Do not attempt to adjust while the vehicle is in motion.**

## Seat adjustments-Front

### Separate Seat



- 1 Position lever
- 2 Lumbar support knob\*
- 3 Seatback angle lever

### Bench Seat

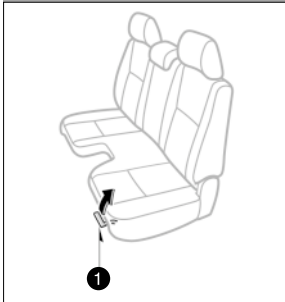

See *Seats* in Section 1-3 of your *Owner's Manual* for more information, including folding, access and double cab seat arrangements.

\*If installed

## Seats-Head restraints

### Separate seat

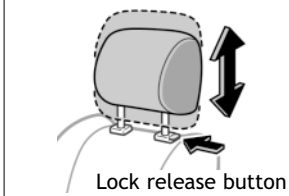

### Bench seat

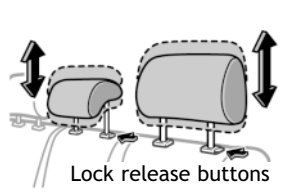

## Accessory meter (if installed)

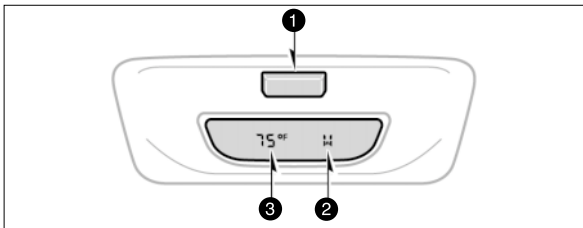

- 1 E/M (English/Metric) button To select Fahrenheit or Celsius.
- 2 Compass
- 3 Outside temperature display

## Lights & turn signals

### Headlights

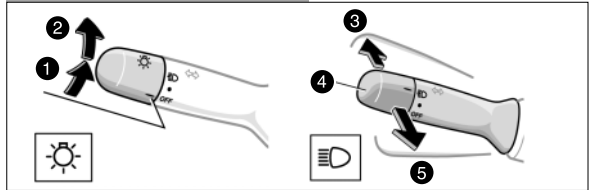

- 1 Parking, tail, license plate and instrument panel lights Twist the lever knob to position 1.
  - 2 Headlights and all of the above Twist the lever knob to position 2.
- Automatic light cut off system This system automatically turns off the lights when the driver's door is opened with the key in "ACC" or "LOCK."
- 3 High beams Push the lever forward.
  - 4 Low beams
  - 5 High beam flasher Pull the lever toward you.

### Turn signals

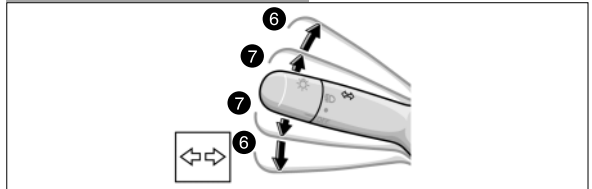

- 6 Right or left turn Push the lever up or down.
- 7 Lane change Move the lever up or down to position 7 and hold.

## Windshield wiper & washer

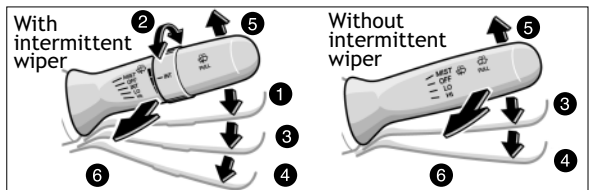

- 1 Intermittent speed Push the lever down to position 1.
- 2 Interval adjuster Twist the band to adjust the intermittent speed.
- 3 Slow speed Push the lever down to position 3.
- 4 Fast speed Push the lever down to position 4.
- 5 Single wipe Push the lever up to position 5.
- 6 Washer fluid Pull the lever toward you.



## Parking brake

### Manual Transmission

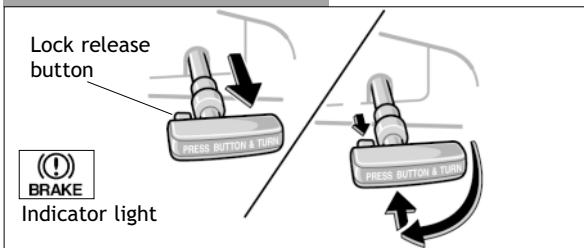

Stick type brake reduces the number of pedals on the floor in Manual Transmission vehicles.

**To set** Pull the lever

**To release** Press the release button, turn the lever and push in.

### Automatic Transmission



**To set** Depress the pedal.

**To release** Depress the pedal again.

## Clock



**To reset the hour** Push the "H" button.

**To reset the minute** Push the "M" button.

## Window-Rear sliding (if installed)



**To open** Push the release lever and slide the window.

## Windows

### Access cab models

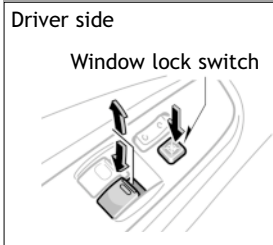

### Double cab models

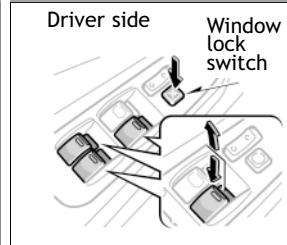

### Window operation

**To open or close** Push down or pull up on the switch.  
**Automatic down operation (Driver side window)**  
 Push the switch completely down and release to fully open.

### Window lock switch

Push the switch to deactivate the passenger windows.

## Cruise control (if installed)

### Turning system on/off

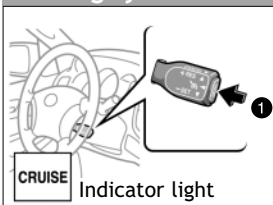

**1 To turn the system "ON" or "OFF"** Push the button.

**2 To set a speed** Bring your vehicle to the desired speed. Push the lever down toward "- SET."

**3 To cancel the set speed** Pull the lever to "CANCEL." The set speed may also be cancelled by either of the following:

- Depress the brake pedal.
- Depress the clutch pedal (manual transmission).

**4 To resume set speed after cancel** Push the lever up toward "+ RES."

Refer to your *Owner's Manual* for more details.

### Setting a speed

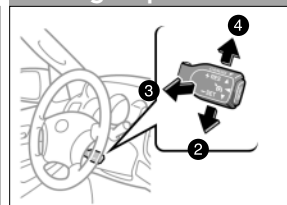

## Audio

### Type 1

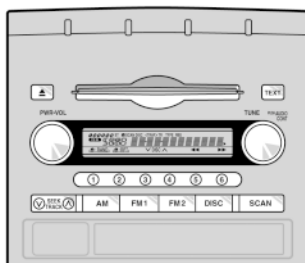

\*Functions for buttons 1-6 are indicated above each button on LCD.

### Type 2



\*Functions for buttons 1-6 are indicated above each button on LCD.

### Type 3

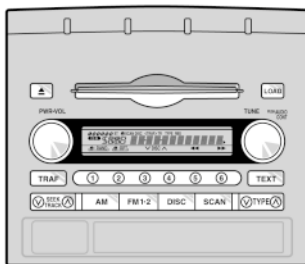

\*Functions for buttons 1-6 are indicated above each button on LCD.

## BASIC OPERATION

**To turn on the audio system** Push "PWR·VOL," "AM," "FM1," "FM2," "FM1·2," "DISC" or "LOAD."  
**To turn off the system** Push "PWR·VOL."  
**To adjust the volume** Turn "PWR·VOL."

## RADIO

**To select a station** Push either side of "SEEK/TRACK."  
**To scan stations** Push "SCAN" (Push and hold to scan preset stations). Push again to hold selection.  
**To select the band** Push "AM," "FM1," "FM2" or "FM1·2."

**To preset a station** Tune in the desired station and press a preset button (1-6) until you hear a beep.  
**To select a preset station** Push desired preset button (1-6).

Type 3 only is equipped with ...

- 1 RDS (Radio Data System) Text Display Push "TEXT" to receive information transmitted from radio stations.

## CD PLAYER

**To play** Insert a compact disc.  
**To select a track** Push "SEEK/TRACK."  
**To scan tracks on a disc** Push "SCAN." Push again to hold selection.  
**To eject a compact disc** Push "▲."  
**To view CD text** Push "TEXT" to display disc information. Refer to your *Owner's Manual* for more details.

Type 2 and 3 only are equipped with ...

- 1 CD Changer  
**To load one disc** Push "LOAD" and insert 1 disc.  
**To load multiple discs** Push and hold "LOAD" until you hear a beep. Insert one disc. Shutter will close and then re-open for next disc.

## Steering wheel switches (if installed)

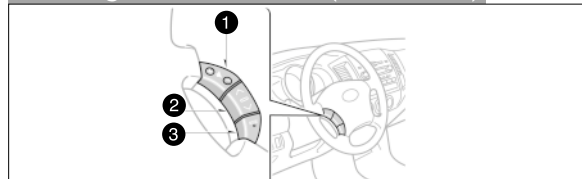

- 1 Volume control switch
- 2 " ^ v " switch  
**In radio mode** Push to select a preset station, or push and hold to seek the next strong station.  
**In CD mode** push to skip up or down to the next or previous track.
- 3 "MODE" switch Push to select an audio mode. Push and hold to turn the audio system "OFF." Refer to your *Owner's Manual* for more details.

## Air conditioning (if installed)/Heating

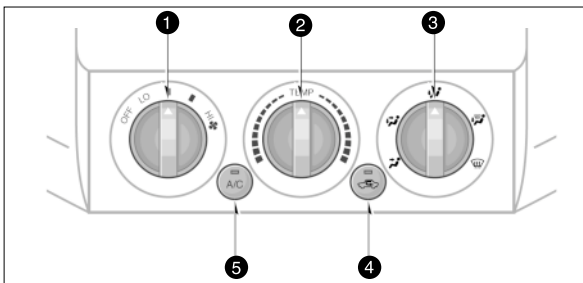

- 1 Fan speed selector
- 2 Temperature selector
- 3 Air flow selector
- 4 Recirculation switch To clear windshield quickly, selecting “” or “” on the air flow selector will automatically set to fresh air (indicator off). “” will allow manual setting to recirculate. “” will only operate in fresh air mode.
- 5 “A/C” switch\* Air conditioning on/off switch.

\*If installed

## Power outlets

### 12V DC



Designed for car accessories. Key must be in the “ACC” or “ON” position to be used.

### 115V AC (if installed)

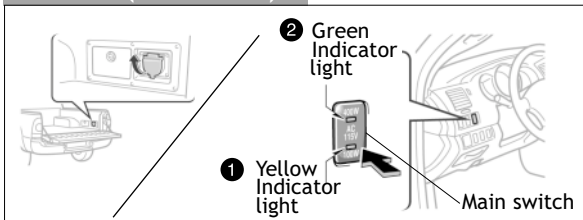

To use Push the Main switch while engine is running.

- 1 Yellow Light Only Max Capacity 115V AC/100W
- 2 Green & Yellow Lights Max Capacity 115V AC/400W

NOTE: Vehicle must be stationary to get full 400W. Refer to your Owner’s Manual for more details.

## Bottle holders

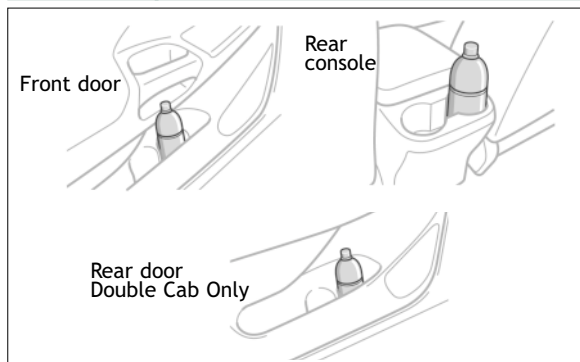

## Cup holders

### Front console

Bench Seat and Separate Seats with A/T (Automatic Transmission)

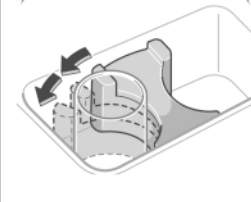
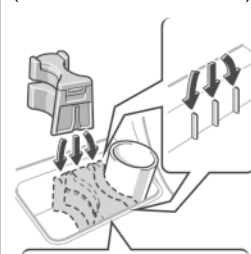

### Center console

Separate Seats A/T (Automatic Transmission)



Separate Seats M/T (Manual Transmission)



## Engine immobilizer (if installed)

This is a theft deterrent system. The engine will start only when the electronic code in the key’s transponder chip corresponds to the registered ID code for the vehicle. Please note that key replacement can be expensive.

Refer to your *Owner’s Manual* for more details.

## Keyless entry

### Locking operation

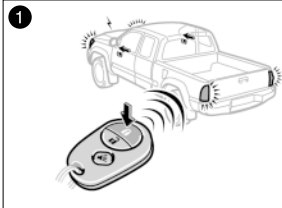

### Unlocking operation

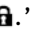
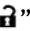
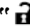

- 1 To lock Push “.”
- 2 To unlock driver door Push “” once.  
To unlock all the doors Push “” twice.

**NOTE:** After unlocking, if a door is not opened within thirty (30) seconds, all doors will relock for safety.

### Alarm button



- 3 To activate alarm with remote Push “.”

Refer to your *Owner's Manual* for more details.

## Rear differential lock (if installed)

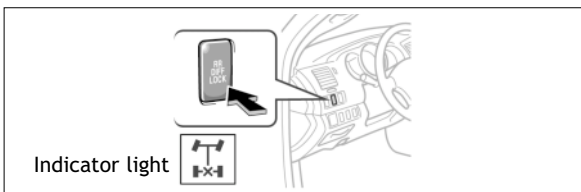

This system is for use **ONLY** when wheel spinning occurs in a ditch, slippery or rough surface. **DO NOT USE THE REAR DIFFERENTIAL LOCK IN CONDITIONS OTHER THAN SPECIFIED IN THE OWNER'S MANUAL, AND UNLOCK THE DIFFERENTIAL ONCE THE VEHICLE MOVES OUT OF THE TROUBLE SPOT.**

Refer to your *Owner's Manual* for complete details on this system before attempting to use it.

## Auto LSD (Auto Limited Slip Differential) (if installed)

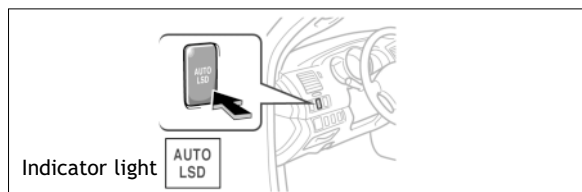

**To use the Auto LSD (Auto Limited Slip Differential)** Push the “AUTO LSD” switch when the vehicle is stopped. To deactivate, push the switch again. It will **ONLY** work in 2-wheel drive.

This system aids traction by helping to control engine performance and braking when one of the rear wheels begins to spin. It should **ONLY** be used when wheel spinning occurs in a ditch or on rough surfaces.

Refer to your *Owner's Manual* for complete details on this system before attempting to use it.

## Clutch start cancel switch (if installed)

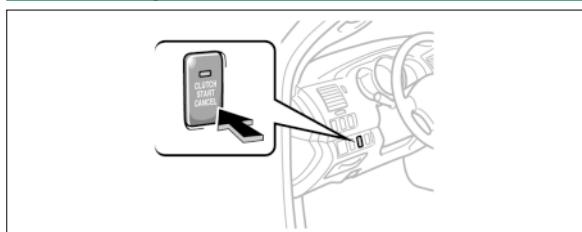

**To crank the engine without depressing the clutch pedal** This feature should only be used in emergency situations. Push the switch, with the ignition “ON,” to cancel the clutch start system.

The clutch start system is designed to keep the starter motor from operating if the clutch is not depressed all the way down. This helps prevent accidental lunging forward of the vehicle when turning on the ignition. **NEVER USE THE SWITCH FOR NORMAL ENGINE STARTING.**

Refer to your *Owner's Manual* for complete details on this system before attempting to use it.

# SAFETY AND EMERGENCY FEATURES

## Door locks

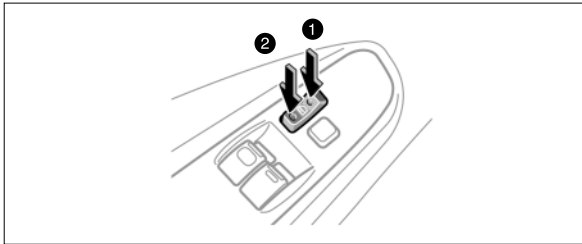

- 1 To lock Push down on the front of the switch.
- 2 To unlock Push down on the back of the switch.

## Doors-Child safety locks (double cab only)

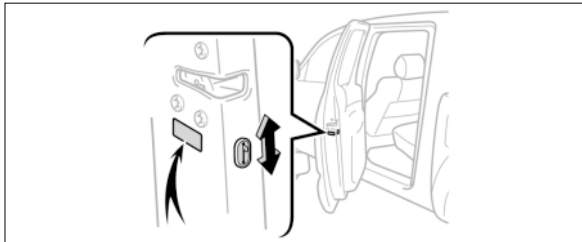

**To lock the inside handle** Move the lever to "LOCK," allowing the door to be opened only from the outside.

## Seat belts

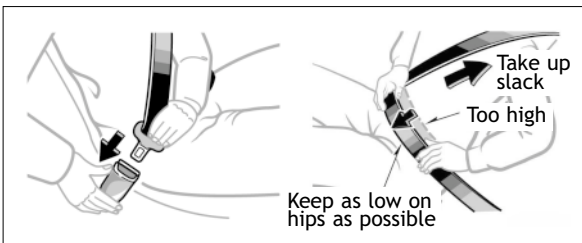

If belt is fully extended, then retracted even slightly, it cannot be re-extended beyond that point, unless it is fully retracted again. This feature is used to help hold a child restraint system securely.

To find more information about seat belts, and how to install a child restraint system, refer to your *Owner's Manual*.

## Seat belts-Shoulder belt anchor

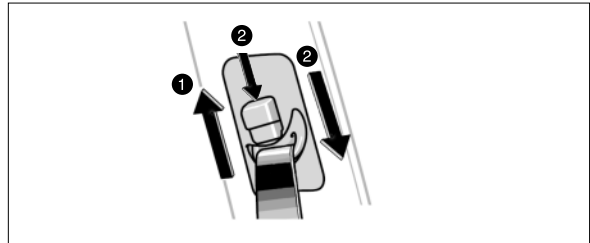

- 1 To raise Slide the anchor upward.
- 2 To lower Squeeze the lock release button and slide the anchor downward.

## DAC (Downhill Assist Control) (if installed)\*

**To turn on/off** Push the DAC button. This system will only work in L4 (Low speed position, four-wheel drive), at under 15 mph. It will assist the deceleration of the engine brake when driving down a steep hill.

## HAC (Hill-start Assist Control) (if installed)\*

**Automatic Transmission only** Assists when starting up a steep or slippery hill. When on, the indicator light will flash and an alarm will sound intermittently.

## TRAC (Traction Control) (if installed)\*

Helps control spinning of the wheels, which may occur when accelerating on slippery roads.

## VSC<sup>1</sup> (Vehicle Stability Control) (if installed)\*

Helps provide comprehensive control of the anti-lock brakes<sup>2</sup>, traction control, engine control and other systems. This system helps prevent the vehicle from skidding under adverse conditions.

\*Refer to your *Owner's Manual* for more details.

<sup>1</sup> Vehicle Stability Control (VSC) is an electronic system designed to help the driver maintain vehicle control under adverse conditions. It is not a substitute for safe driving practices. Factors including speed, road conditions and driver steering input can all affect whether VSC will be effective in preventing loss of control.

<sup>2</sup> ABS (Anti-lock Brake System) is not a substitute for safe driving practices. Braking effectiveness also depends on proper brake-system maintenance and tire and road conditions.

### Passenger airbag cutoff switch (if installed)\*

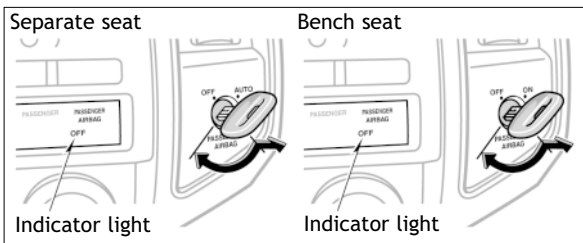

**To turn on** Turn the key to "ON" or "AUTO."

**To turn off** Turn the key to "OFF" and remove the key.

\*Regular and Access Cab Models Only. Refer to your *Owner's Manual* for more details.

**NOTE: SEE BELOW FOR INFORMATION ABOUT THE FRONT PASSENGER OCCUPANT CLASSIFICATION SYSTEM\*, AND NOTE THAT IF THE INDICATOR LIGHT IS FLASHING, THE SYSTEM IS DETECTING SOMEONE OR SOMETHING IN THE SEAT WITHOUT A SEATBELT.**

### Airbag-Supplemental Restraint System

The Airbag Supplemental Restraint System (SRS) front, side\* and side curtain\* airbags are designed to help provide further protection for the driver and outboard passenger in addition to the primary safety protection provided by the seat belts.

**Front passenger occupant classification system (separate seat only)\*** This system detects the conditions of the front passenger, and based on these conditions, it activates or deactivates the front passenger airbags.

**For the system to correctly determine conditions**

- Do not put a heavy load on the front passenger seat.
- Do not attach a seatback table to the front passenger seatback.
- Do not put weight on the front passenger seat by putting your hands or feet on the front passenger seatback from the rear passenger seat.

Please read the following caution, and refer to your *Owner's Manual* for more details.

\*If installed

### CAUTION

- The driver and front passenger airbag Supplemental Restraint System (SRS) is designed only as a supplement to the primary protection of the seat belt systems of the driver and front passenger. The front seat occupants are particularly susceptible to injury if they do not wear their seat belts; when sudden braking or a collision occurs, they may be thrown forward. To obtain maximum protection in an accident, the driver and all passengers in the vehicle should always wear their seat belts when driving because serious injuries or death can result to unrestrained occupants. For instructions and precautions concerning the seat belt system, see "Seat belts" in the *Owner's Manual*.
- Toyota strongly urges the use of a proper child restraint system on the rear seat that conforms to the size of the child. According to accident statistics, a child is safer when properly restrained in the rear seat than on the front seat.
- Never** use a rear-facing child restraint system in the front seat even if the front passenger airbag manual on-off switch or occupant classification indicator light is "OFF." The force of the rapid inflation of the passenger airbag can cause severe injury or death to a child.
- Unless it is unavoidable, do not install a forward-facing child restraint system in the front seat even if the front passenger airbag manual on-off switch or occupant classification indicator light is "OFF." If you must install a forward-facing child restraint system in that the front seat, move the seat as far back as possible.
- Make sure you have complied with all installation instructions provided by the child restraint manufacturer and the system is properly secured.
- Make sure the front passenger occupant classification indicator light indicates "ON" when using the seat belt extender for the front passenger seat. If the indicator light indicates "OFF," disconnect the extender tongue from the seat belt buckle, then reconnect the seat belt. Reconnect the seat belt extender after making sure the indicator light indicates "ON." If you use the seat belt extender while the indicator light indicates "OFF," the front passenger airbag and side airbag on the front passenger side may not activate correctly, which could cause death or serious injury in the event of collision.
- If an adult sits in the front passenger seat, the occupant classification indicator light should indicate "ON." If the "OFF" indicator is illuminated, ask the passenger to sit up straight, well back in the seat, feet on the floor, and with the seat belt worn correctly. If the "OFF" indicator still remains illuminated, either ask the passenger to move to the rear seat, or if that is not possible, move the front passenger seat fully rearward.
- The SRS side and side curtain airbags (optional) are designed to deploy in certain types of severe side impact collisions. In all other collisions, the side impact and side curtain airbags will not deploy. For instructions and precautions, see your *Owner's Manual*.
- Do not lean against the side doors when the vehicle is in use. The side and side curtain airbags inflate with considerable speed and force. Death or serious injury could result.
- Do not modify, cover or replace the surface of the front seats. Such changes could disable the system or prevent the airbags from activating correctly, resulting in death or serious injury.





## Rollover Information

This vehicle will handle and maneuver differently from an ordinary passenger car because it is also designed for off-road use. It has a higher ground clearance and higher center of gravity than an ordinary passenger car. This vehicle design feature causes this type of vehicle to be more likely to roll over. Utility vehicles have a significantly higher rollover rate than other types of vehicles.

An advantage of the higher ground clearance is a better view of the road allowing you to anticipate problems. However, it is not designed for cornering at the same speeds as ordinary passenger cars any more than low-slung sports cars are designed for off-road use. Therefore, sharp turns at excessive speeds may cause rollover.

Failure to operate this vehicle correctly may result in loss of control, accidents or vehicle rollover causing death or serious injury. Be sure to read your Owner's Manual for more information on safe driving both on and off-road.

 <b>WARNING: HIGHER ROLLOVER RISK</b>		
	<p>Avoid Abrupt Maneuvers and Excessive Speed.</p> <p>Always Buckle Up.</p> <p>See Owner's Manual For Further Information.</p>	

Always observe the following precautions to minimize the risk of serious personal injury or damage to your vehicle:

- In a rollover crash, an unbelted person is significantly more likely to die than a person wearing a seat belt. Therefore, the driver and all passengers should fasten their seat belts whenever the vehicle is moving.
- Avoid sharp turns or abrupt maneuvers, if at all possible. Failure to operate this vehicle correctly may result in loss of control or vehicle rollover causing death or serious injury.
- Avoid loading any items on the roof that will raise the vehicle's center of gravity.
- Always slow down in gusty crosswinds. Because of its profile and higher center of gravity, your vehicle is more sensitive to side winds than an ordinary passenger car. Slowing down will allow you to have better control.
- When driving off-road or in rugged terrain, do not drive at excessive speeds, jump, make sharp turns, strike objects, etc. This may cause loss of control or vehicle rollover causing death or serious injury. You are also risking expensive damage to your vehicle's suspension and chassis.
- Do not drive horizontally across steep slopes. Driving straight up or straight down is preferred. Your vehicle (or any similar off-road vehicle) can tip over sideways much more easily than forward or backward.

## Spare tire & tools

### Tool location

Regular cab models  
-behind the seatback



Double cab models  
-under the rear seat

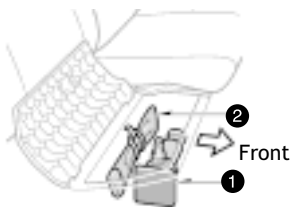

Access cab models  
-under the rear seat

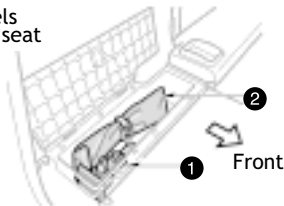

- 1 Jack
- 2 Tool bag

### Removing the spare tire

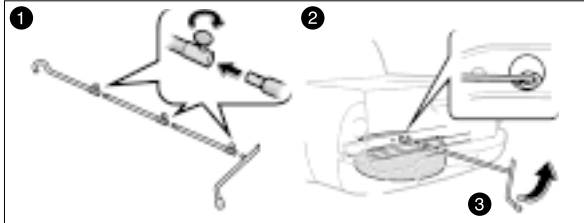

- 1 Assemble the jack handle.
- 2 Insert the jack handle end into the lowering screw.
- 3 Turn the jack handle counterclockwise.

Refer to your *Owner's Manual* for jack positioning and tire changing procedures.



If you have any questions or comments  
please contact the Toyota Customer  
Assistance Center at 1-800-331-4331,  
or visit our informative, interactive  
Web site at <http://www.toyota.com>



©2004 Toyota Motor Sales, U.S.A., Inc.  
00452-PRG05-TAC